

# Apartment Specifications

Gross Area: 131.11 sq.m.

Area Of Balconies: 11.36 sq.m.

## The Building:

- Elegant building lobby, including floor to ceiling tiling.
- Intercom system at main entrance.
- Elegant elevator with Shabbat mode.
- Outdoor lighting.

## The Apartment:

- 80/80 granite porcelain floor tiling with an option for a parquet flooring in the master bedroom. 4 colors of choice.
- External Intercom for apartment with an option to upgrade and add a screen.
- Entrance door with "Rav Bariach" locking mechanism.
- Interior doors by "Pandoor" (or equivalent) with high quality hardware.
- Aluminum windows and balcony doors, including insulating glass, manufactured by "Kilil" or equivalent manufacturer.
- Electric shutter in living room (with a manual option for Shabbat).
- Three phase 3x40 ampere electricity.
- Electric outlets according to electricity plan, including two Shabbat clocks.
- Gewiss light switches & sockets.
- Underfloor heating for entire apartment.
- Mini central air conditioner.
- Solar water heating system with 150 liter capacity.

## Shower room:

- 30/60 wall tiling. 4 designs of choice and a variety of strip décor tiles.
- 33/33 Anti slip floor tiling. 4 designs of choice.
- Luxurious bathroom vanity closet with an integral sink and mirror.
- Wall hung toilet with concealed toilet tank ("Grohe") including dual flushing system.
- Cold water and drain pipe for washing machine.

## Kitchen:

- Sandwich wood with Formica finish, including built in unit, high quality hardware, soft close hinges/runner system and flap cabinets.
- High quality caesarstone working surface. 5 colors of choice.
- Granite porcelain tiling between work surface and top cabinets in variety of sizes.
- Two kitchen sinks, flush mounted.
- Two pull out faucets.

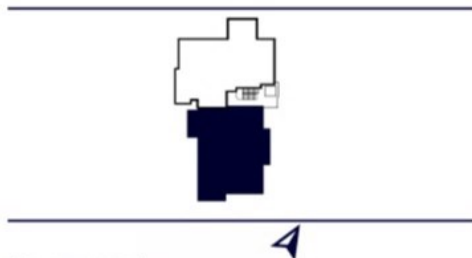

For illustrative purpose only